

RENEWAL PARTS

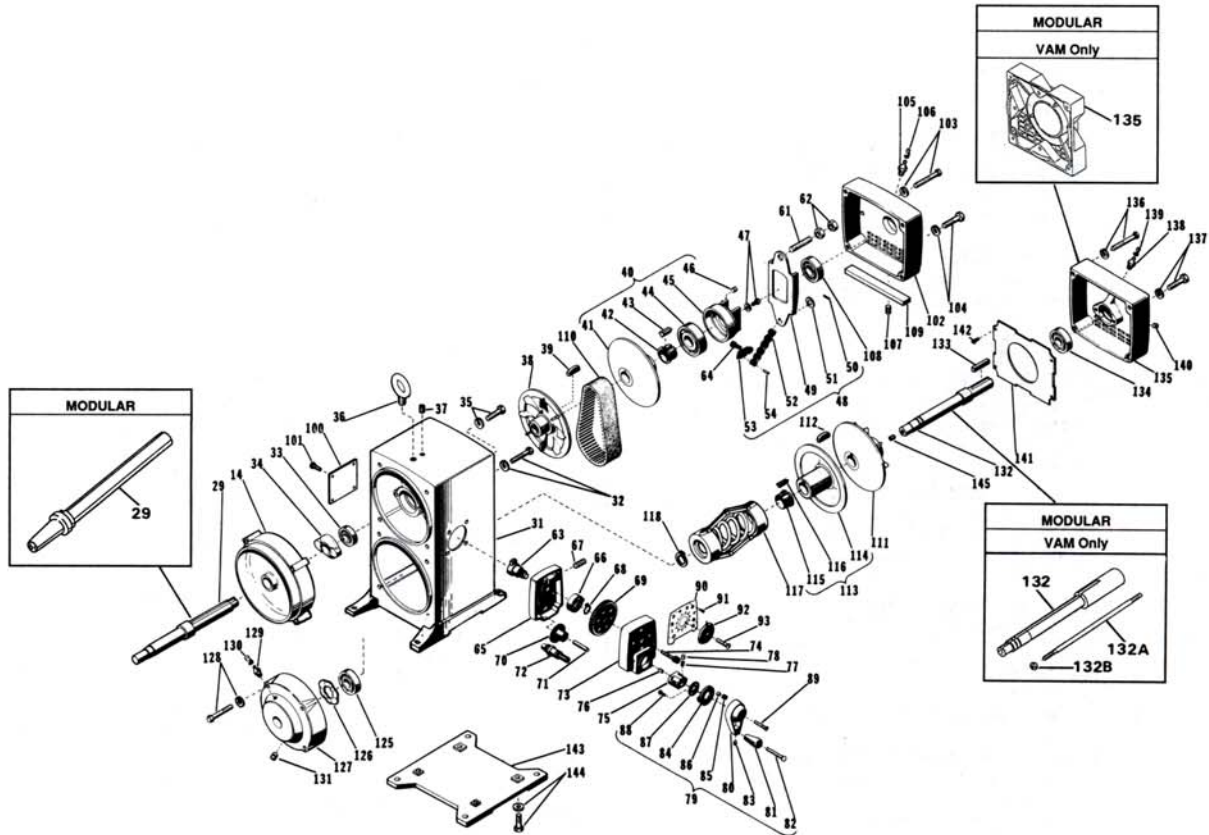

PARTS LIST

FRAME 25 — TYPES VE, VEU, VEV-1, VEU-1, VEUF-1, VAP, VAM — VARIDRIVE FRAME ASSEMBLY WITH V-KEY



ITEM NO.	QTY.	NAME OF PART
1-13	-	Not Used
14	1	Adaptor Bracket (LF Motor Only)
15-28	-	Not Used
29	1	Motor Shaft or Input Shaft
30	-	Not Used
31	1	Frame Case
32	4	Hex Head Cap Screw & Lockwasher (Frame to Stator) (Not Used on VEU-1 or VEUF-1)
33	1	Ball Bearing (Position #10) (Refer to Section 775)
34	1	Bearing Cap (Not Used on VEUF-1)

PRICES:

Parts stocking distributors: refer to your USEM renewal parts numerical index.
 All others: refer to your nearest USEM parts stocking distributor.



RENEWAL PARTS



PARTS LIST

FRAME 25 — TYPES VE, VEU, VEV-1, VEU-1, VEUF-1, VAP, VAM — VARIDRIVE FRAME ASSEMBLY WITH V-KEY

ITEM NO.	QTY.	NAME OF PART
35	2	Hex Head Cap Screw & Lockwasher (Frame to Bearing Cap)
36	1	Eyebolt (Qty. 2 on VE & VEUF-1)
37	1	Slotted Headless Pipe Plug (Not Used on VEUF-1)
38	1	Stationary Motor VARIDISC
39	1	Bowed Key
40	1	Adjustable Motor VARIDISC Assembly (Includes Items 41 thru 46)
41	1	Adjustable Motor VARIDISC (Sold as Assembly Only)
42	2	Shaft Bushing
43	1	ENDOLUBE Wedge
44	1	Ball Bearing (Position #9) (Refer to section 775)
45	1	Shifting Bearing Housing
46	1	Slotted Headless Pipe Plug
47	2	Round Head Cap Screw & Lockwasher
48	1	Control Arm Assembly (Includes Items 49 thru 54)
49	1	Shifting Lever
50	1	Spring Pin (Lever to Chain)
51	1	Special Washer
52	1	Roller Chain
53	1	Cam
54	1	Spring Pin (Chain to Cam)
55-60		Not Used This Assembly
61	1	Stud
62	2	Hex Jam Nut
63	1	Cam Shaft
64	2	Socket Head Cap Screw (Cam to Shaft)
65	1	Adaptor Plate Assembly (Included in Item 73) Sold as Assembly Only
66	1	Speed Stop Collar
67	1	Socket Set Screw (Speed Stop)
68	1	Retaining & Snap Ring
69	1	Helical Gear
70	1	Cluster Gear
71	1	Dowel Pin
72	1	Pinion
73	1	Control Housing Assembly
74	3	Fillister Head Machine Screw
75	1	Locking Cam
76	1	Square Key (Cam to Pinion)
77	2	Compression Spring
78	2	Dowel Pin
79	1	Handwheel Assembly (Includes Items 80 thru 88)
80	1	Handwheel
81	1	Handle
82	1	Pivot Pin
83	1	Socket Set Screw
84	1	Clutch Plate
85	2	Compression Spring
86	2	Steel Ball
87	1	Clamping Plate
88	2	Round Head Machine Screw
89	1	Flat Head Machine Screw (Handwheel)

ITEM NO.	QTY.	NAME OF PART
90	1	Dial Plate
91	4	Self-Tapping Screw
92	1	Pointer Assembly
93	1	Oval Head Screw (Pointer)
94-99		Not Used This Assembly
100	1	Cover Plate (Not Used on VE)
101	4	Round Head Machine Screw (Not Used on VE)
102	1	Front Plate Cover
		Support Bracket (VEUF-1 ONLY)
103	2	Hex Head Cap Screw & Lockwasher
104	2	Hex Head Cap Screw & Lockwasher (VEU-1 & VEUF-1 Only)
105	1	Grease Fitting (VEUF-1 Only)
106	1	Plastic Cap (VEUF-1 Only)
107	1	Slotted Headless Pipe Plug (VEUF-1 Only)
108	1	Ball Bearing (Position #8A) (VEUF-1 Only) (Refer to section 775)
109	1	Seal
110	1	VARIBELT (Refer to section 732, page 1)
111	1	Stationary Driven VARIDISC
112	1	Bowed Key
113	1	Adjustable Driven VARIDISC Assembly (Includes Items 114 thru 116)
114	1	Adjustable Driven VARIDISC (Sold as Assembly Only)
115	2	Shaft Bushing
116	1	Endolube Wedge
117	1	Spring Compensator Assembly
118	1	Retaining Snap Ring
119-124		Not Used This Assembly
125	1	Ball Bearing (Position #8) (Refer to section 775)
126	1	Wave Spring Washer
127	1	Support Bracket
128	4	Hex Head Cap Screw & Lockwasher
129	1	Grease Fitting
130	1	Plastic Cap
131	1	Slotted Headless Pipe Plug
132	1	Output Shaft; 132A Stud; 132B Hex Nut
133	1	Square Key
134	1	Ball Bearing (Position #7) (Refer to section 775) (Not on VAM)
135	1	Pulley End Bracket
136	2	Hex Head Cap Screw & Lockwasher
137	2	Hex Head Cap Screw & Lockwasher
138	1	Grease Fitting
139	1	Plastic Cap
140	1	Slotted Headless Pipe Plug
141	1	Air Deflector
142	4	Self-Tapping Screw
143	1	Mounting Base (VEU-1 & VEUF-1 Only)
144	4	Hex Head Cap Screw & Lockwasher (VEU-1 & VEUF-1 Only)
145	1	Slotted Headless Pipe Plug (Shaft)

WARNING:

Any disassembly or repair work on explosionproof motors will void the Underwriter's Laboratories, Inc. label unless done by the manufacturer, or a facility approved by the Underwriter's Laboratories, Inc.. Refer to your nearest U.S. Electrical Motors office for assistance.

PRICES:

Parts stocking distributors: refer to your USEM renewal parts numerical index.
All others: refer to your nearest USEM parts stocking distributor.

